

90° Zinc Die-Cast Connectors

For use with metallic and non-metallic liquid tight conduit, type B only.

CATALOG NUMBER	UPC/DCI/NAED MFG #018997	TRADE SIZE	KO SIZE	UNIT PKG	STD PKG	DIM A	DIM B	DIM C
LT9038	32938	3/8	1/2	10	50	2.062	.520	2.340
LT9050*	32950	1/2	1/2	10	50	2.128	.525	2.312
LT9075	32970	3/4	3/4	10	50	2.515	.510	2.664
LT90100	32910	1	1	5	25	2.260	.675	3.640
LT90125*	32913	1-1/4	1-1/4	2	10	3.362	.700	3.750
LT90150*	32915	1-1/2	1-1/2	2	10	3.500	.604	4.235
LT90200*	32920	2	2	2	10	4.106	.680	4.800



*MADE IN USA.

With Insulated Throat

CATALOG NUMBER	UPC/DCI/NAED MFG #018997	TRADE SIZE	KO SIZE	UNIT PKG	STD PKG	DIM A	DIM B	DIM C
LT9038A	32931	3/8	1/2	10	50	2.062	.520	2.340
LT9050	32951	1/2	1/2	10	50	2.128	.525	2.312
LT9075A	32971	3/4	3/4	10	50	2.515	.510	2.644
LT90100A	32911	1	1	5	25	2.260	.675	3.640
LT90125A	32912	1-1/4	1-1/4	2	10	3.362	.700	3.750
LT90150A	32955	1-1/2	1-1/2	2	10	3.500	.604	4.235
LT90200A	32921	2	2	2	10	4.106	.680	4.800
LT90250	32925	2-1/2	2-1/2	1	1	5.215	.870	5.625
LT90300	32930	3	3	1	1	6.500	.950	6.500
LT90350	32935	3-1/2	3-1/2	1	1	6.715	.950	7.450
LT90400	32940	4	4	1	1	7.000	.950	8.000



E60812 LR49636

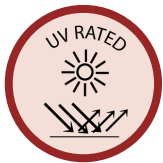

LT9050



LT90150

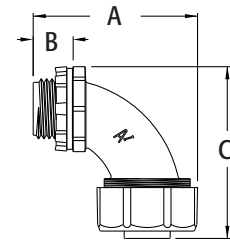

LT9050A



LT90150A

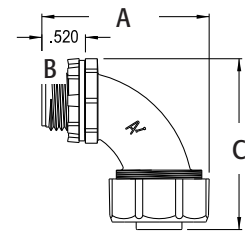

LT9038A

LIQUID TIGHT