



Mueller Streamline Co. Headquarters

150 Schilling Blvd
Suite 201
Collierville, Tennessee 38017
United States
Phone: 901 753 3200

Mueller Streamline Co. International

525 Okeechobee Blvd
Suite 860
West Palm Beach, FL 33401
United States
Phone: 561 273 8300

ITEM # AC17869, CYCLEMASTER® BALL VALVES - STANDARD WITH ACCESS PORT

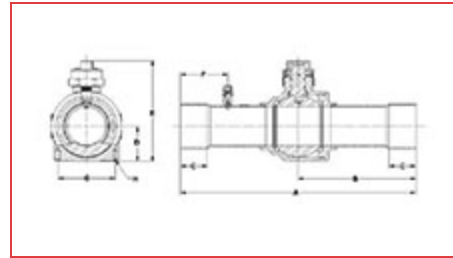

[Specifications](#) | [Dimensions](#)

Specifications

Connection Size	2 5/8 in
Cv	401.00
Kv	347
Port	2.44 in
MAP	48 bar 700 psi
Weight	6.26 kg 13.81 lb
Seal Cap Kit	A 17845
Operating Temperature [Min]	-40 °C -40 °F

Operating Temperature [Max]149 °C
300 °F**Dimensions**

A	13.50 in 343 mm
B	6.75 in 171 mm
C Min	1.47 in 37 mm
D	2.19 in 56 mm
E	5.92 in 150 mm
F	2.85 in 72 mm